

# INSUduct Fixing Instructions (WITH GROUNDBREAKER)

**1.** Select location for Groundbreaker\* / INSUduct. Choose an option for installation (through wall **A** or under footings **B**) Locate water service pipes as required.  
Compliant with Building Regulations and Water Regulation Guide (G7.1 & G7.2), line the hole in the wall with a short length of pipe and insulate with at least 32mm of insulation (not supplied with INSUduct).

\*INSUduct can be used with or without Groundbreaker.

**2.** Open the packaging and put aside screws and fixings for future use. Remove back plate (black plastic) and offer to wall or post. Mark fixing points (a minimum of 4 required). Put aside the back plate and drill the wall with a 6mm drill bit. Insert wall plugs and then fix back plate to wall / post with the screws provided (38mm No.10).

**3.** Take rear insulation part, align to top of backplate and press firmly on to the lugs provided.

**4.** Cut out appropriate slots in insulation and INSUduct outer shell for pipework.

**5.** Ensure the front insulation is correctly in the outer cover.

**6.** Apply the outer cover (with insulation within) onto location lugs on back plate and fix with 6 No.19mm No.10 S/T screws provided.  
*Clean backfill excavation as required.*

**INSUduct**   
GB0107

**Please note that Groundbreaker installation can be made before or after the installation of INSUduct. For 'climbing' INSUduct, repeat instructions rising up the face of the building (Bellmouth Fitting).**

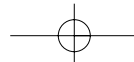

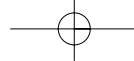

# INSUduct™ Fixing Instructions (WITHOUT GROUNDBREAKER)

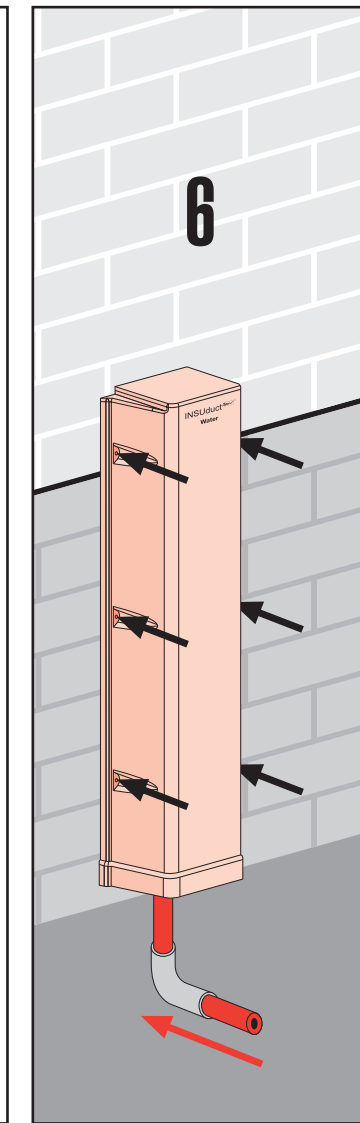
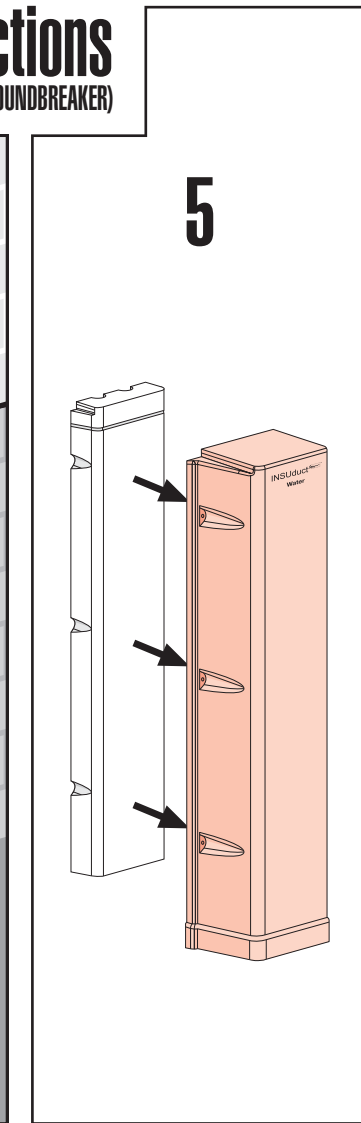
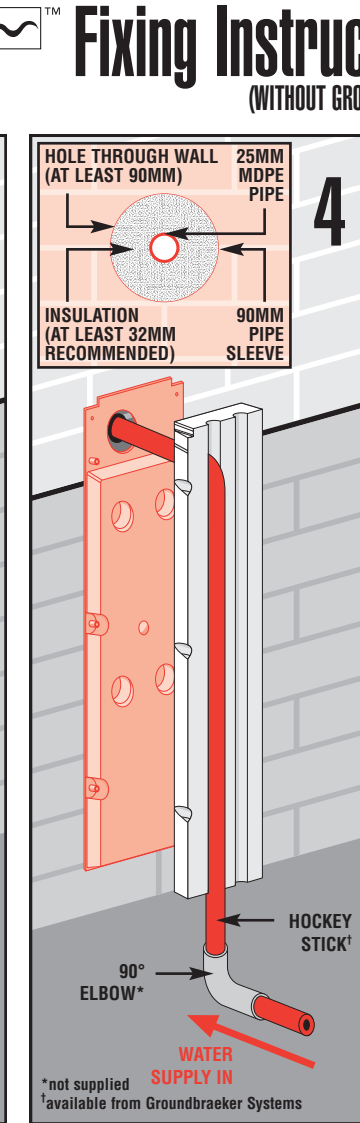
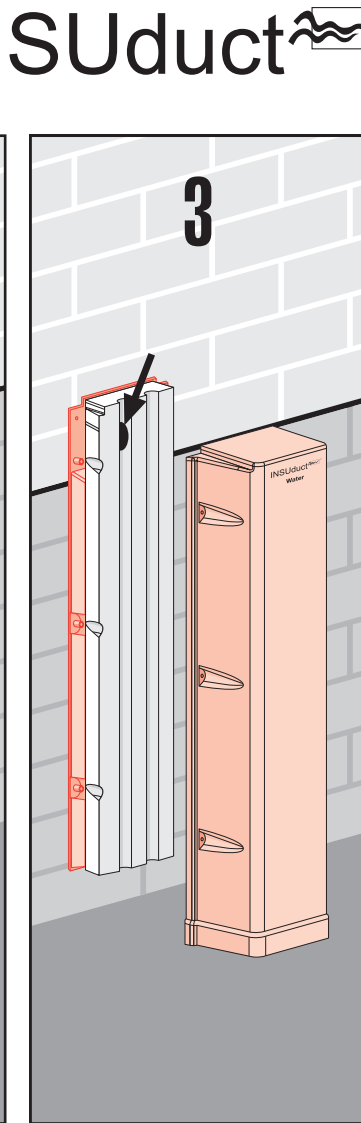
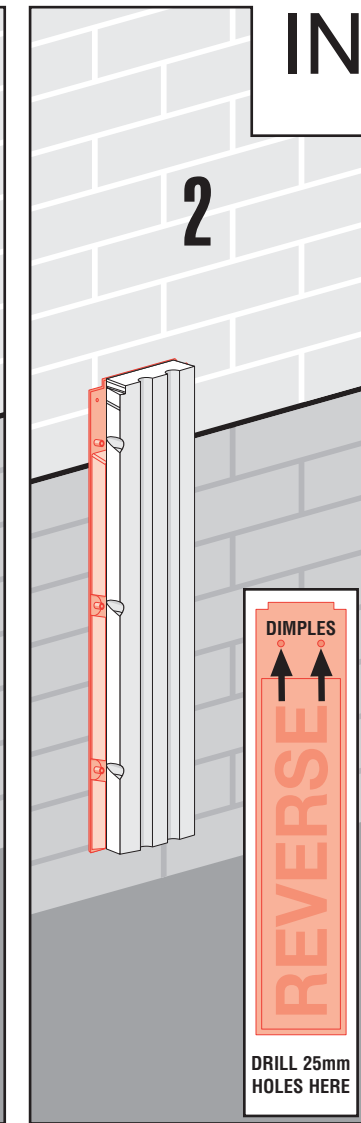
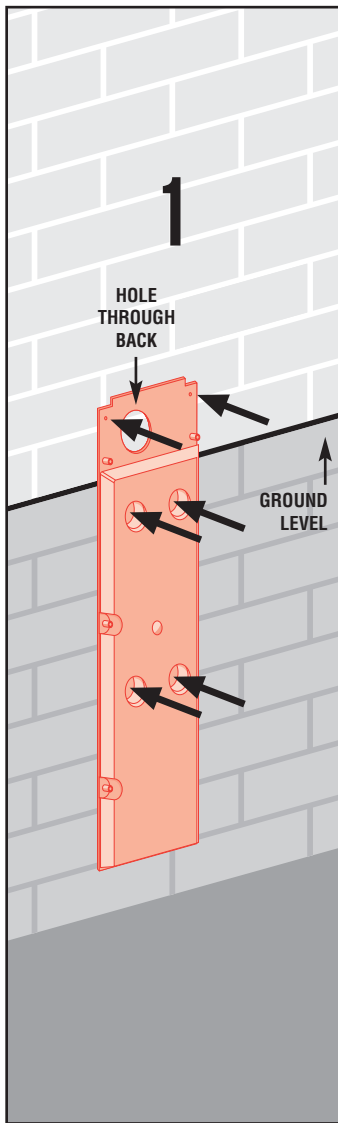

**1.** Locate water service pipes and select location for INSUduct as required. Open the packaging and put aside screws and fixings for future use. Remove back plate (black plastic) and offer to wall or post. Mark fixing points (a minimum of 4 is required). Put aside the back plate and drill the wall with a 6mm drill bit. Insert wall plugs and then fix back plate to wall / post with the screws provided (38mm No.10).

**2.** Take rear insulation part, align to top of backplate and press firmly on to the lugs provided.

**3.** Cut out appropriate slots in insulation and INSUduct outer shell for pipework.

**4.** Bring water service pipe to 'hockey stick' using a 90° elbow or as required.  
Compliant with Building Regulations and Water Regulation Guide (G7.1 & G7.2), line the hole in the wall with a short length of pipe and insulate with at least 32mm of insulation (not supplied with INSUduct).

**5.** Ensure the front insulation is correctly in the outer cover.

**6.** Apply the outer cover (with insulation within) onto location lugs on back plate and fix with 6 No.19mm No.10 S/T screws provided.  
*Clean backfill excavation as required.*

**For 'climbing' INSUduct, repeat instructions rising up the face of the building (Bellmouth Fitting).**

# INSUduct™

